

Axial Cutting Tools with scalable Cutting Diameter and Fine-adjustment

■ All Axial-Cutting Tools without Insert Holders

DIN 69871 MAS-BT

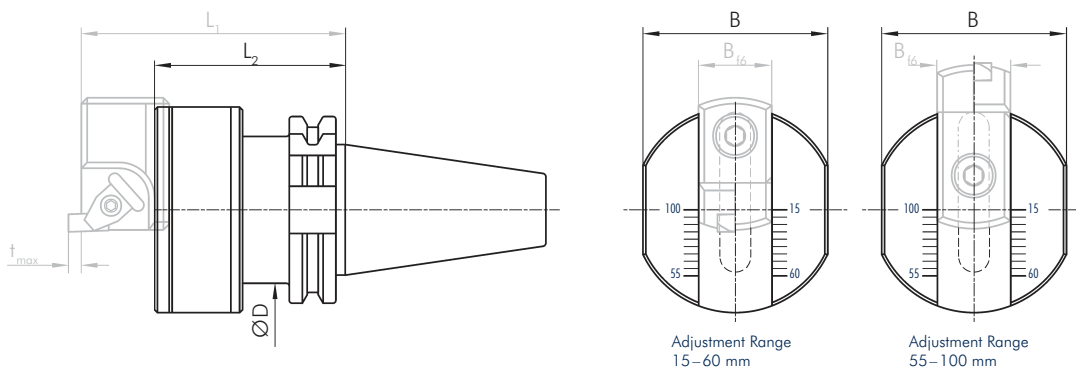

Order No.	Adjustment Range Ø mm	Shank size	Insert size	L1 mm	L2 mm	B mm	Bf6 mm	D mm	tmax. mm
133134	15 – 100	SK 40	A 6R	90	65	63	25	40	4,0
133151	15 – 100	SK 50	A 6R	90	65	63	25	75	4,0
133109	55 – 100	BT 40	A 6R	90	65	63	25	40	4,0

DIN 69893

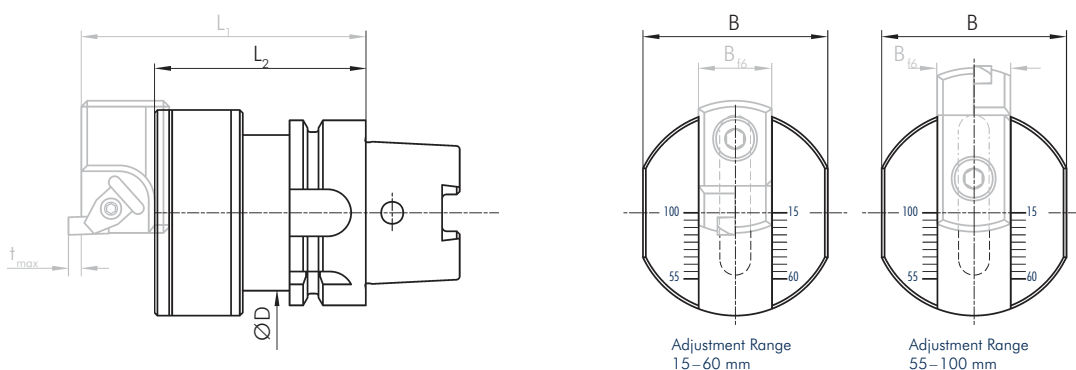

Order No.	Adjustment Range Ø mm	Shank size	Insert size	L1 mm	L2 mm	B mm	Bf6 mm	D mm	tmax. mm
133118	15 – 100	HSK 63	A 6R	97	72	63	25	53	4,0

Komet® ABS

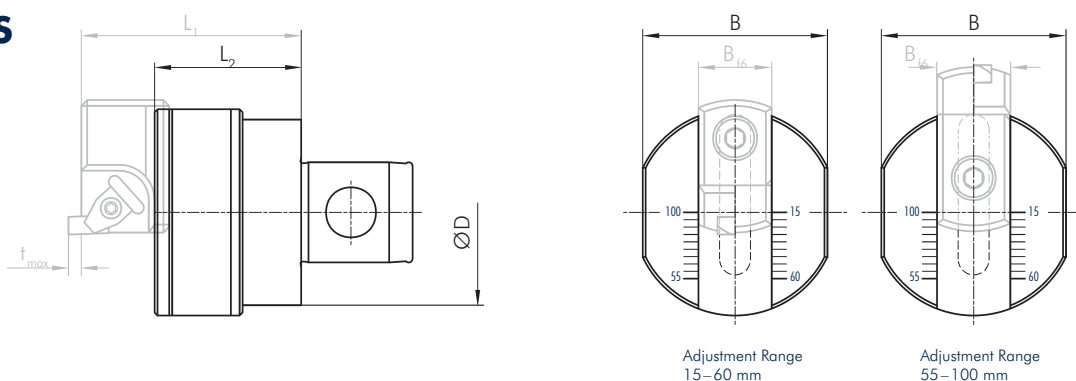

Order No.	Adjustment Range Ø mm	Shank size	Insert size	L1 mm	L2 mm	B mm	Bf6 mm	D mm	tmax. mm
133096	15 – 60	ABS 50	A 6R	75	48	63	25	50	4,0
133135	15 – 100	ABS 63	A 6R	75	50	63	25	63	4,0

Insert Holders

■ Special-Insert holders on request

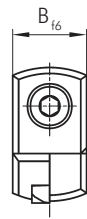
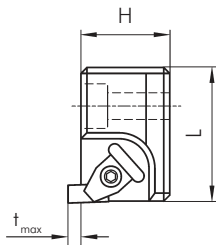

Adjustment Range
15-60 mm

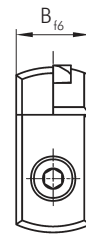

Adjustment Range
55-100 mm

Order No.	Adjustment Range Ø mm	Insert size	L mm	Bf6 mm	H mm	tmax. mm	Spare part No.	
							Clamping claw	Screw
133117	15 - 60	A 6R	45	25	30	4,0	107540	114688
133090	55 - 100	A 6R	62	25	30	4,0	107540	114688

Screw torque 0,9 Nm

Unprofiled Carbide Inserts

■ Cutting data see page 181

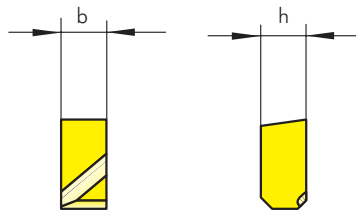

Righthand version shown

Size	Design	b	h	K10	P25	FKN
A 6R	right	6	6	142841	142770	142855

Various forms of insert profiles.
Other profiles according to DIN or drawing are available on request.



Order form for Axial Cutting Inserts

Size	Ø Dmin. - Dmax. mm	Please note your cutting width mm	K10	P25	FKN	TiAlNF
A 6R right	15-25					
A 6R right	23-40					
A 6R right	35-60					
A 6R right	55-85					
A 6R right	75-100					
A 6R right	95-100					

Function and Handling

Technical Data

Complete tool, consisting of

- Axial-Cutting-Tool
- 2 insert holders for cutting range
 - a) 15 – 60 mm
 - b) 55 – 100 mm

Advantages

This tool makes operations possible in workpieces, which cannot be clamped on turning machines.

Applications

Making grooves (DIN- or special grooves) up to a

- Cutting depth of max. 4,0 mm
- Cutting width of max. 6 mm

Rough Adjustment

1. Removing the clamping screw
2. Rough adjustment of the insertholder over the screening system (2,5 mm)
3. Low tighten the clamping screw

Fine Adjustment

1. Fine adjustment over the fine adjustment screw
2. Tighten the clamping screw

